

abbotFox



Yarmouth Road, Norwich
£800 PCM

“

We are a team of genuine individuals who hold a deep passion for both property and marketing. Collectively, we bring over 70 years of experience in the property market of Norfolk and Suffolk. Our affection for both counties runs deep, and we are enthusiastic about sharing our passion with you.

Colin McKenzie | **Branch Partner**







THE DETAIL _____

£800-£825 abbotFox presents this well-presented and spacious one-bedroom bungalow is situated in the highly desirable suburb of Thorpe St Andrew, offering comfortable and convenient living in a popular residential location. The property comprises a generous lounge with plenty of natural light, a fitted kitchen with ample storage, a modern bathroom, and a well-proportioned double bedroom. Externally, the property benefits from a small private garden area, ideal for enjoying outdoor space with minimal maintenance.

Thorpe St Andrew is located to the east of Norwich and is widely regarded as one of the city's most sought-after suburbs. The area offers an excellent range of local amenities, including supermarkets, independent shops, schools, doctors and dental surgeries, as well as access to picturesque riverside walks along the River Yare. There are regular and reliable bus services providing easy access into Norwich city centre, while Norwich train station—approximately 2 miles away—offers direct links to Cambridge and London, making this an ideal location for commuters and professionals alike.

THE HIGHLIGHTS _____

- Recently fully renovated
- Spacious One Bedroom Bungalow
- Envidable Location
- Bathroom
- Kitchen
- Lounge
- Small Garden Area

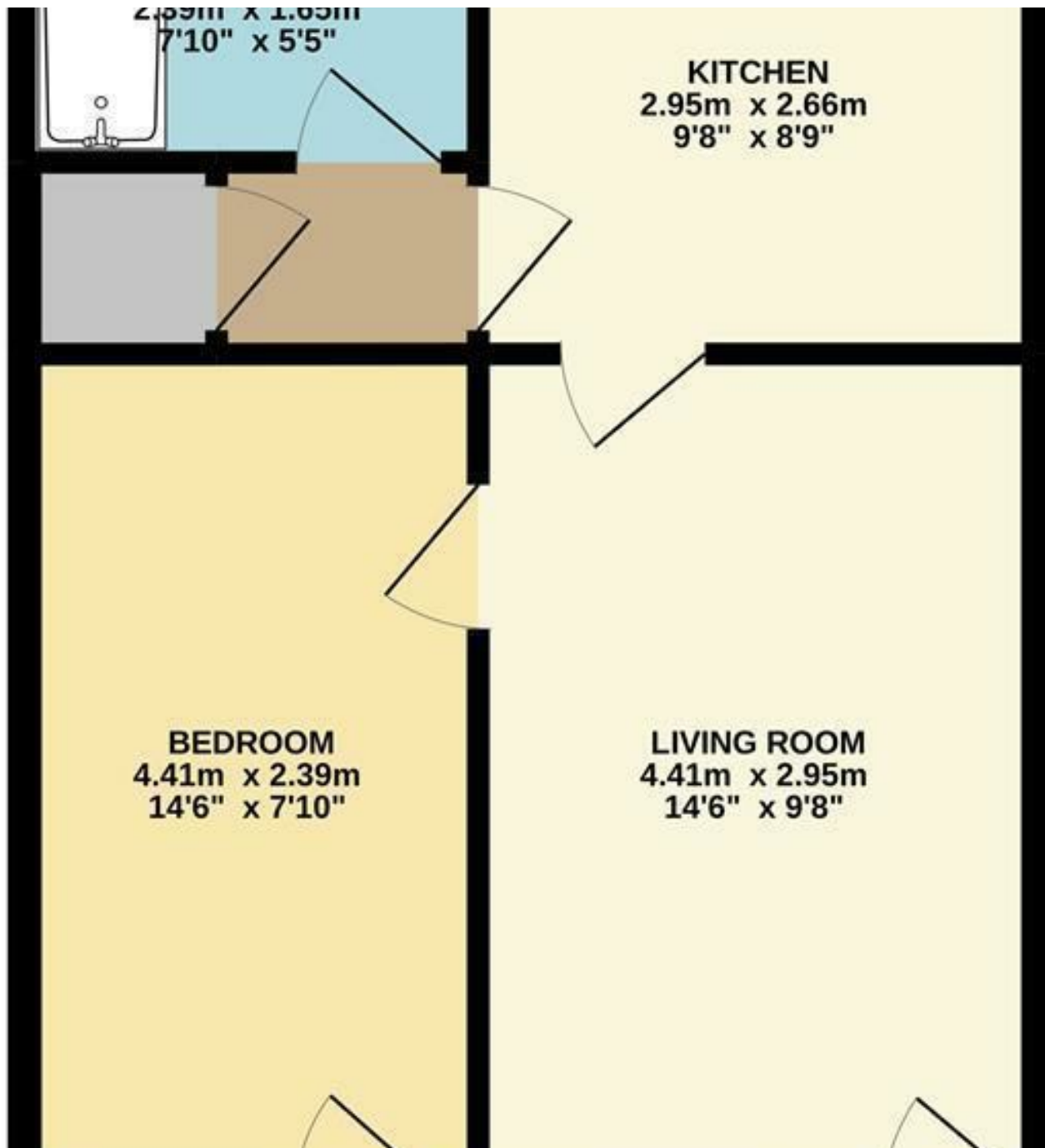

Let's talk

01603 660000

sales@abbotfox.co.uk

@abbotfox

EPC RATING -

Disclaimer – In accordance with the Property Misdescriptions Act, the company abbotFox gives notice that all descriptions, references to condition, necessary permissions for use and other details are given in good faith and believed to be correct, but any purchaser should not rely on them as statements of fact, and must satisfy themselves by inspection or other means, as to their accuracy.